



Item # 05-0000100 05/05 © 2015 Steelcase Inc. All rights reserved. All specifications subject to change without notice. Printed in U.S.A. on 30% post-consumer recycled paper. Trademarks used herein are the property of Steelcase Development Corporation or of their respective owners. The GREENGUARD name is used under license through the GREENGUARD Environmental Institute.

Call 800.333.9939 or  
visit [www.steelcase.com](http://www.steelcase.com)

**Steelcase®**

Do what you do better.™

**Steelcase®**

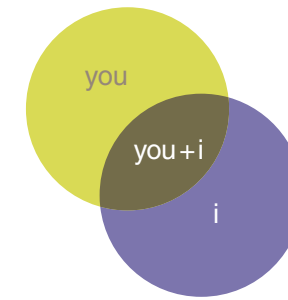

Foster ideas, improve negotiation, speed problem solving. It sounds like every corporation's wish list. So why not design spaces that make it happen?

Research shows that virtually all innovation is the result of two people working together. Not one person, not a group, but two. Workplace products have been designed for individuals and for groups – but this is the first research-based product that expressly addresses one and two person work. Introducing Duo™, a workstation solution that leverages the unique power of the pair.

Our observational research revealed that the majority of dyadic interaction happens within individuals' personal workstations, not in designated meeting spaces. Our product designers used this insight to evolve the personal workstation. We focused on making it easy for people to transition from "I" work to "You and I" work, reflecting how they spend nearly 80% of their workday. The result is a high-performance workstation for the individual that supports working in pairs.

Finnish researchers studying business networks found that nearly all entrepreneurial and strategic actions within a company come out of two people working together.

Evolving the personal workstation means better meeting the needs of the individual. Within their own space people want privacy, control, and the ability to easily interact with others when they choose. Duo product solutions help create this balance. Duo products are designed to be applied in a way that creates three patent-pending zones within the workstation: private zone, dyadic zone, and public zone.

### personal space

Observing how people work in pairs confirmed that the workstation must remove barriers to valuable, dynamic interactions with others. At the same time, a productive space for one person must provide shelter from distractions. Duo products create a personal space that lets people concentrate in the “I” work mode, while “windows” into the workstation allow neighbors to quickly interact. Workers are accessible but not on display. Openings in the workstation give people a better sense of their environment and help create a perception of more space, giving each worker the impression of a larger workstation without increasing square footage.



The private zone is created using privacy screen, panels and storage that act as space definition. The dyadic zone allows team members to talk from their workstations and hosts to collaborate with guests. The public zone invites guests to approach the workstation.





Duo Overhead Storage is mounted on open supports to allow neighbors to talk while seated in their workstations. Duo Tall Storage and Slim Storage are positioned at a height that acts as a privacy screen and personal storage when seated, and a shared worksurface when standing.

A test group of office workers that we used to prove (or disprove) our theories confirmed that the shared worksurface on top of Tall Storage and Slim Storage typically becomes a neutral zone, used for collaboration.



## the power of two

Duo products enhance people working in pairs by creating dyadic zones. Ever notice that casual interactions between neighbors often begin by talking over the fence, or in the case of a workstation, the panel? It's a brief exchange, too brief to come into the other person's space. It's quickly sharing information or getting a fast answer to a question.

Longer dyadic interactions involve bringing guests into the workstation. Our research showed that collaborative sessions often begin with a question over the fence and move further inside the workstation as the conversation progresses. Whether it's planned or

spontaneous, the ideal posture for this sort of interaction, where two people build on each other's ideas and share tools, is shoulder-to-shoulder. When working shoulder-to-shoulder, the dynamic shifts from "you're working in my space" to "we're working together." Leaning across the desk or standing behind the other person to see the computer screen are awkward and unequal postures people tend to adopt because typical workstation design doesn't accommodate working side-by-side. Duo solutions, combined with other Steelcase products, support side-by-side work. The new Airtouch™ adjustable worksurface goes from sitting to standing in an instant with just a light touch so both people can work at the same level.

**Learning is better in twos.** A British psychologist noted that how much people learn is limited when they work alone. When two people work together they build on each other's ideas, going farther with their learning.

## public entry

The public zone resides at the outside edges of the workstation. An effective public zone should allow people to move about outside the workstation without disturbing the private zone. The public zone also serves as a passageway into the workstation for collaboration. Both verbal and nonverbal signals invite a guest into the workstation. However, if the space doesn't support dyadic work, guests are more likely to stay at the edge of the workstation, or the pair will

adopt awkward postures in an attempt to share the space. Duo products bring guests into the workstation by creating an approachable public zone that naturally flows guests into the dyadic zone.

Is a pair different than a group? A Swiss sociologist found that when a pair became a group of three a major change occurred in the interaction. He concluded that the group provides new social opportunities, however the group limits each person's ability for expression. Similarly, Australian educational researchers found that when a third person was added to a pair the interaction became more complex and students arrived at solutions slower than when they worked in pairs.



Panels and privacy screens define the public and private zones. People can pass by without disruption. Guests approach the workstation from the front to begin a conversation. If collaboration continues they can move easily around curved work-surfaces to enter the dyadic zone.



## Product Application

The Duo portfolio of products gives design professionals unique application options for defining the private zone, controlling the public zone and harnessing the power of the pair. Duo products give you the freedom to design small or large workstations, open or panel based workstations.



Duo Tall Storage between the workstations provides storage, seated privacy, and a shared worksurface when standing. Pathways Privacy Screens on the worksurfaces can be mounted up or down to provide two different levels of visual privacy.



A dynamic team setting is created using Duo Overhead Storage and Duo Slim Storage. Coworkers have easy access to each other, and each user's personal zone is defined.



Low-height panels and Duo Tall Storage frame the workstations. Duo Overhead Storage allows team members to talk from within the workstations, while providing separation and storage.



Duo Slim Storage and a secondary worksurface provide space for spreading out documents. A low-height panel and Duo Slim Storage encourage collaboration.



Duo Slim Storage between the workstations provides storage, seated privacy, and a shared worksurface when standing. Duo Tall Storage is mounted to Pathways Post and Beam in a library-like configuration.



Pairs can work side-by-side at long workstations, collaborate over the Duo Tall Storage, or talk under the Duo Overhead Storage.



Pathways Post and Beam Fence, Universal Worksurfaces, and Duo Slim Storage create open workstations that are framed by panels for a greater degree of privacy.



Pairs working side-by-side can easily move around the curved worksurfaces. Duo Tall Storage supports collaboration between coworkers, while defining the personal zone.

## Duo Statement of Line

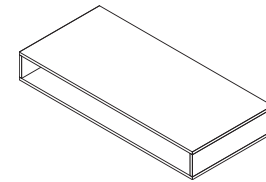

Duo Slim Storage - 54"W

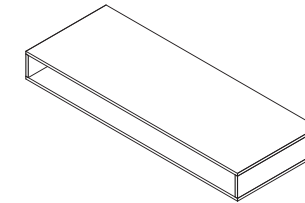

Duo Slim Storage - 66"W

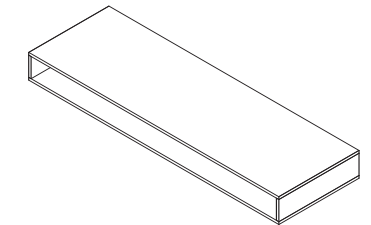

Duo Slim Storage - 78"W

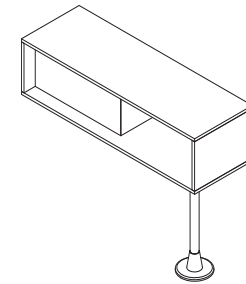

Duo Tall Storage - 54"W

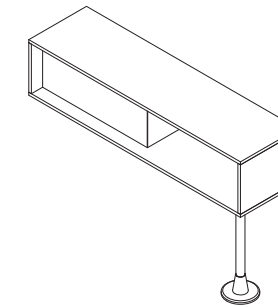

Duo Tall Storage - 66"W

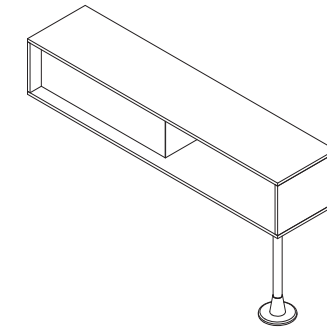

Duo Tall Storage - 78"W

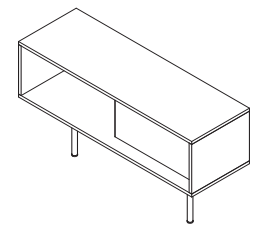

Duo Overhead Storage - 54"W

## Works With

Duo works with a broad range of Steelcase products including: Pathways® Post and Beam, Pathways Technology Wall, Answer® systems, Montage® systems, Universal Worksurfaces and Universal Storage.

## Surface Materials

**Laminates:** 2790 Arctic White or Open Line Laminates

**Paint:** All price groups, including Perfect Match Paint

**Legs and Brackets:** 4799 Platinum

See the System Solutions Specification Guides for additional information (beginning November 2005)

### Global Dealer Network

We speak your language. Over 400 Steelcase dealers in North America, plus more than 500 Steelcase dealers internationally, help you create inspiring workspaces just about anywhere. Whether your project is across town, across the country, or across the ocean, our dealer network will coordinate the logistics so you don't have to. It's local expertise with a global reach.

### Steelcase and Dealer Services

It's more than a product, it's a partnership. Our service offering includes workspace evaluations, space planning, project coordination, installation, maintenance, asset management, and much more. Tailored web-based solutions make it easy to purchase what you need and manage what you have. And financing alternatives provide flexible leasing options.

### Environmental Commitment

Being an environmentally responsible company starts by asking questions. That's why we carefully analyze all our actions and strive to grow more environmentally effective each day. This means considering the entire life cycle of our products – from raw materials to the day that product is no longer needed. And when that day does come (many years from now) the Steelcase Environmental Partnership program will connect you with resources to donate, refurbish, or recycle your unused Steelcase products.